

linear connection
using
180° bars



90° angle
connection using
90° bars



φ° angle
conecion using
 φ° bars



When segments of the Ubase mount must be interconnected to create a uniform continuous railing, either on a straight line or at an angle, depending on the construction's needs, metal bars are used which are anchored onto the mount's dents on both segments. It is recommended that three are used for every connection, for an absolutely secured result.

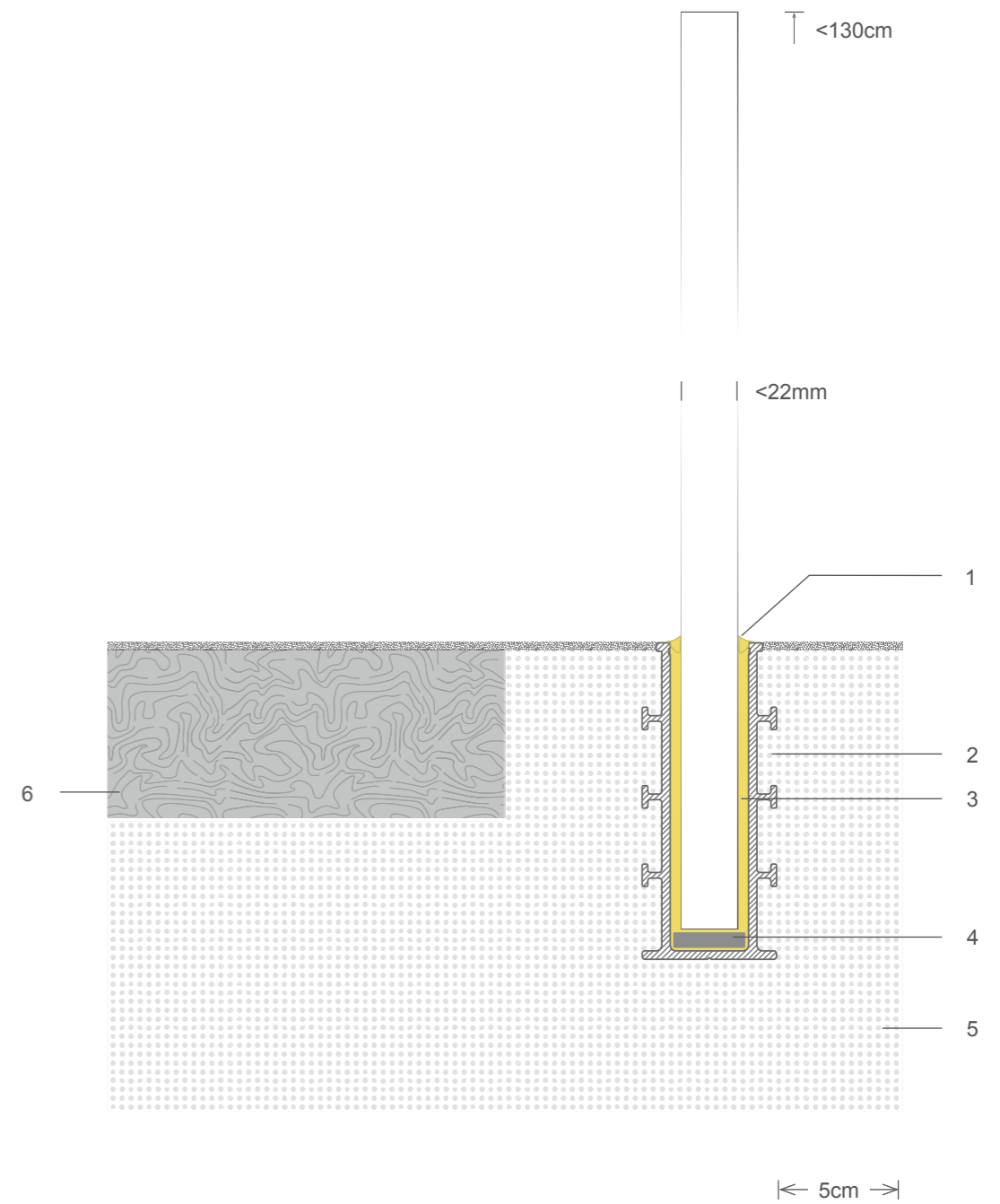

- 1 watertightness with silicon
- 2 anchoring points
- 3 elastomeric resin
- 4 plastic cap
- 5 reinforced concrete
- 6 mortar

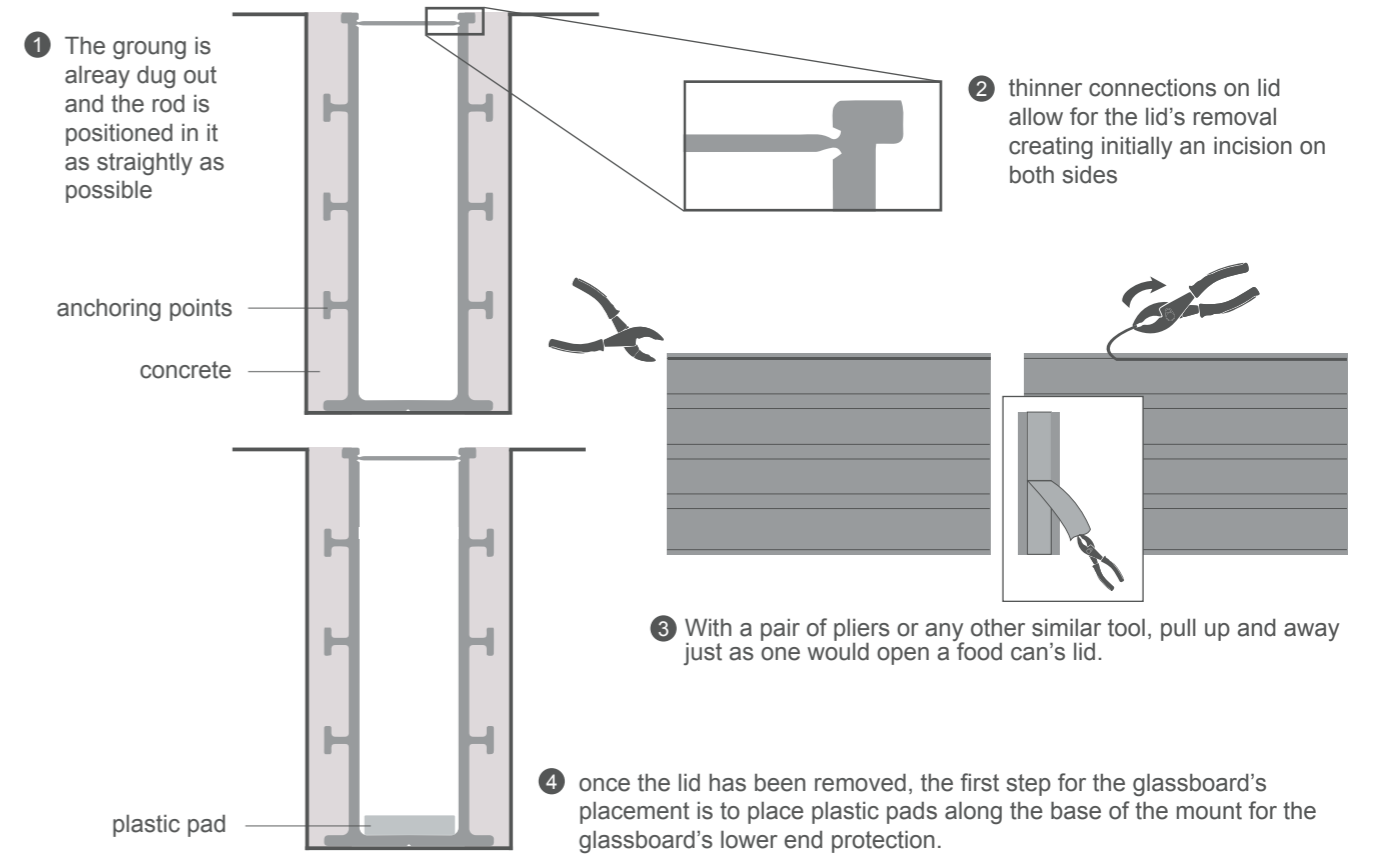

method A - 8+8 or 10+10 glassboards

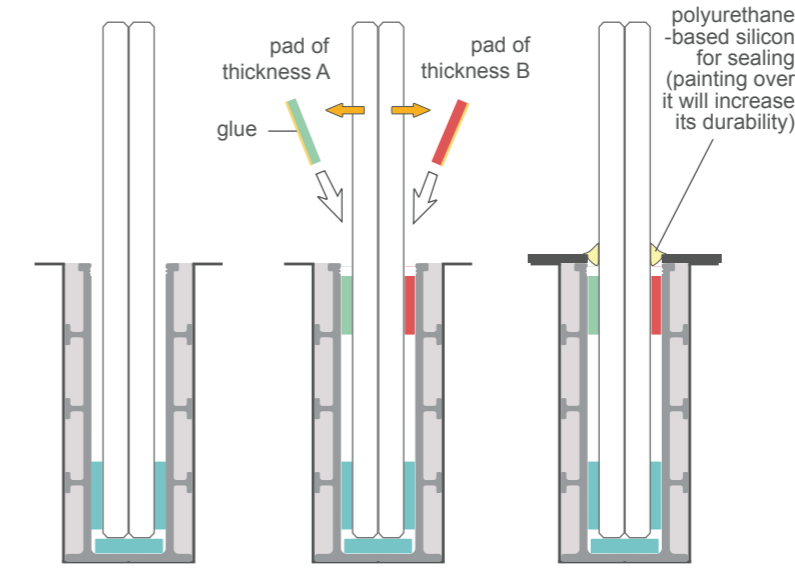

- 5 additional pads of the same thickness are placed on both sides of the glassboard
- 6 another two pads of different thicknesses are placed on both sides of the glassboard for its alignment
- 7 polyurethane-based silicon applied on joint to seal and complete the installation

method B - 8+8 glassboard

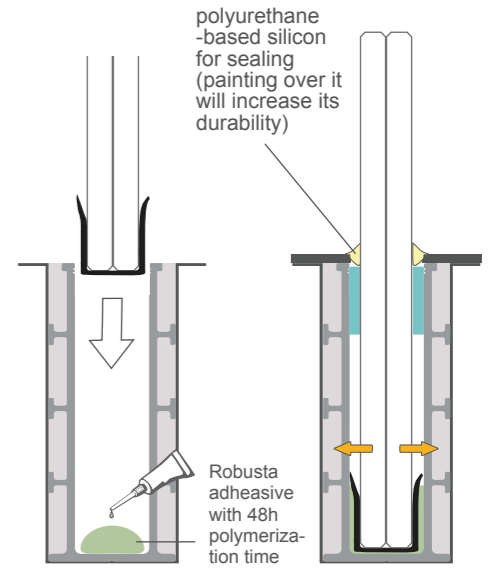

- 5 application of adhesive at points 30 to 40 cm apart and placement of Π-shaped gasket onto the lower end of the glassboard
- 6 glassboard alignment with pads of same thickness on both sides and sealing with polyurethane-based silicon